



Rev. # 3-03

PART #FK1029-2D\FK1029-4D

1995-1999 CHEVY TAHOE 1500 REAR FLIP KIT

INSTALLATION INSTRUCTIONS

Please take the time to read these **INSTALLATION INSTRUCTIONS** and check the **Hardware Parts List** to be sure you have all the listed parts.

These installation instructions are prepared for the professional installer with the proper equipment, tools and experience in suspension systems and safety. This vehicle and its components are extremely heavy and can be dangerous without the proper equipment and experience.

Please read the warranty information (blue page enclosed). Complete your Product Warranty Card and mail it to DJM Suspension.

Please take a few minutes to fill out your installation helper (back side of warranty). Accurate measurements **BEFORE BEGINNING INSTALLATION** will show any irregularities in your vehicle.

NEVER WORK UNDER TRUCK SUPPORTED BY A JACK ONLY !!!
USE QUALITY JACK STANDS WHICH HAVE A RATING ADEQUATE FOR YOUR TRUCKS WEIGHT!!!

Before beginning this installation, compare the new front hanger with the factory mounting holes. If the vehicle has a hanger different from the one in the kit, do not begin installation call DJM Tech 310-538-1583. See page 2 for more details.

USE KIT #FK1029-4D ON 4 DOOR AND #FK1029-2D ON 2 DOOR.

New shocks are required. Use #1509 Driver side & #1800 Pass side.

Hardware Parts List:

Axle Flip Kit

- 2- Axle Locators (1010-A)
- 2- Upper Axle Plates (1010-P)
- 4- 5/8" U-Bolts (1025)
- 8) 5/8" x 18 Nylock Nuts
- 8) 5/8" Flat Washers
- 2- 5/8" x11 x 3-1/2" Tap Bolts
- 2- 5/8" x11 x 4" Tap Bolts
- 8- 5/8" Flat Washers
- 4- 5/8" x11 Nylock Nuts
- 2- Leaf Spring Plates (1025)

Frame Support Kit

- 1- Left Frame Support
- 1- Right Frame Support
- 16- 7/16" x 14 x 1-1/4" Bolts
- 16- 7/16" Flat Washers
- 16- 7/16" x 14 Nylock Nuts
- 2 - Bump Stops(10S)

Shock Extenders

- 2 -Shock Extenders (1128S)
- 2- 3/8" x 16 x 1" Bolts
- 2- 3/8" x 16 Nylock Nuts
- 2- 3/8" Flat Washers
- 2- 1/2" x 13 x 2.75" Bolts
- 4- 1/2" x 20 x 1" Bolts
- 4- 1/2" x 20 Jam Nuts
- 4- 1/2" Flat Washers
- 2- 1/2 x 13 Nylock Nuts
- 8- 1/2" Lock Washers

Front Spring Hanger Kit

- 2- Front Spring Hangers(1028)
- (1028T) 1- Brake Cable Bracket
- 8- 7/16 x 14 x 1-1/4" Bolts
- 8- 7/16" Flat Washers
- 8- 7/16" x 14 Nylock Nuts

Working on one side at a time, remove front and rear spring eye bolts and remove spring from truck. Keep bolts they will be reused to reassemble springs.

Remove factory front spring hangers. Cut a slot in the factory brake cable bracket (drivers side) and move cable away from hanger. The rivets attaching the spring hanger must be removed. You can use an air chisel, or grind them flush and use and punch to drive them through frame. Install new DJM spring hanger using 7/16" x 1-1/4" bolts, washers and nuts. Torque to 60-65 ft/lbs.

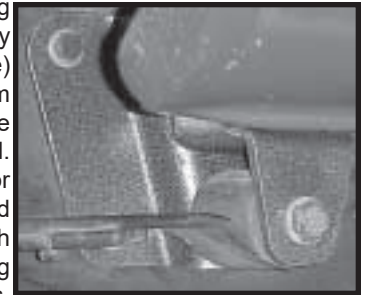

Note : Some installers prefer to bolt the spring to the hanger before bolting to the frame.

Note: Install new DJM brake cable bracket in the upper hole towards front of truck.

Reinstall the leaf spring under the axle. Place the new axle locator bracket on top of the spring, with the off center hole toward front of vehicle. This will center the rear axle and pull the drive shaft back from the transmission slightly. Lower the rear axle into the new axle supports. Rotate axle to desired pinion angle.

Install new U-bolts and spring plates (5 hole) on the bottom of the springs. Cross-torque u-bolts. Over tightening may bend spring plates.

Place the new upper axle plates with the pin down on top of the axle. Install the 5/8" x 4" bolts with one flat washers on top of the upper plate and one on the bottom of the axle locator.





Part # FK1029-4D & FK102-2D cont.



Installing Frame Supports

Frame supports are installed after axle is relocated. Raise the axle, and mark the center on the frame. Use this mark to center the frame support.

Make a template or use one of the brackets and mark the frame. Use a sawzall, cutting wheel or plasma cutter to notch frame. **Do not use a torch!!** Move any wires or brake lines out of the way before cutting. Drill and bolt frame support to frame. Install bump stop to frame support.

Mount new shock extenders to original lower shock mount. New shock will install out and down from original mount. The wide end will be mounted to original mount. Line up shock extender with original shock holes. Attach with two 1/2" x 1" bolts in original holes (Nuts on inside!). Using shock extender as a template line drill a 3/8" hole through original mount and secure with a 3/8" x 1" bolt, washer and nut. Install new shocks to shock extender with 1/2" x 13 x 2.75" bolts and tighten.

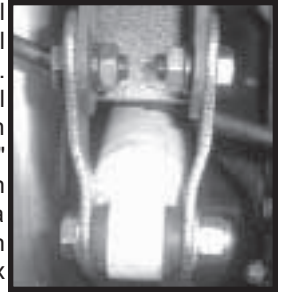

Check all hardware is tightened and test drive. Adjust pinion angle if necessary.

Measure and record completed height on installation helper.

Some Tahoe's may sit low in the rear. Use DJM lifting shackle part #SH1000 to raise the rear.



Check the front hangers before beginning installation. Compare the mounting holes to the hangers included with the kit. If the hanger on the truck is different, do not begin installation, call DJM tech (310-538-1583) for assistance.



Hanger used in FK1029-4D. Mounting hole space wider on upper holes.

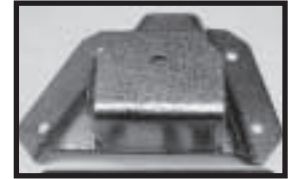

Hanger used in FK1029-2D. Mounting hole space wider on lower holes.

PLEASE ENSURE THAT YOU HAVE THE CORRECT C NOTCH AND HANGER



FK1029-4D
4 DOOR

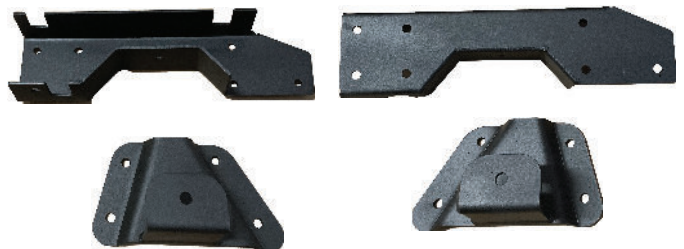

FK1029-2D
2 DOOR